

STATE OF NORTH CAROLINA  
DEPARTMENT OF TRANSPORTATION  
HIGHWAY DIVISION 6

# PLANS

**Let Date: October 18, 2023**

**CONTRACT ID: DF00453**

**TIP NO.: -----**

**FEDERAL AID NO.: STATE FUNDED**

**WBS ELEMENT NO.: 2024CPT.06.05.20092.1**

**ROUTE NO.: VARIOUS**

**LOCATION: VARIOUS**

**COUNTY: BLADEN**

**TYPE OF WORK: ASPHALT SURFACE TREATMENT – DOUBLE & TRIPLE SEALS**

**LENGTH OF PROJECT: 14.50 MILES**

**This electronic collection of documents is provided  
for the convenience of the user  
and is Not a Certified Document –**

**The documents contained herein were originally issued  
and sealed by the individuals whose names and license  
numbers appear on each page, on the dates appearing  
with their signature on that page.**

**This file or an individual page  
shall not be considered a certified document.**

# Bladen County AST Contract

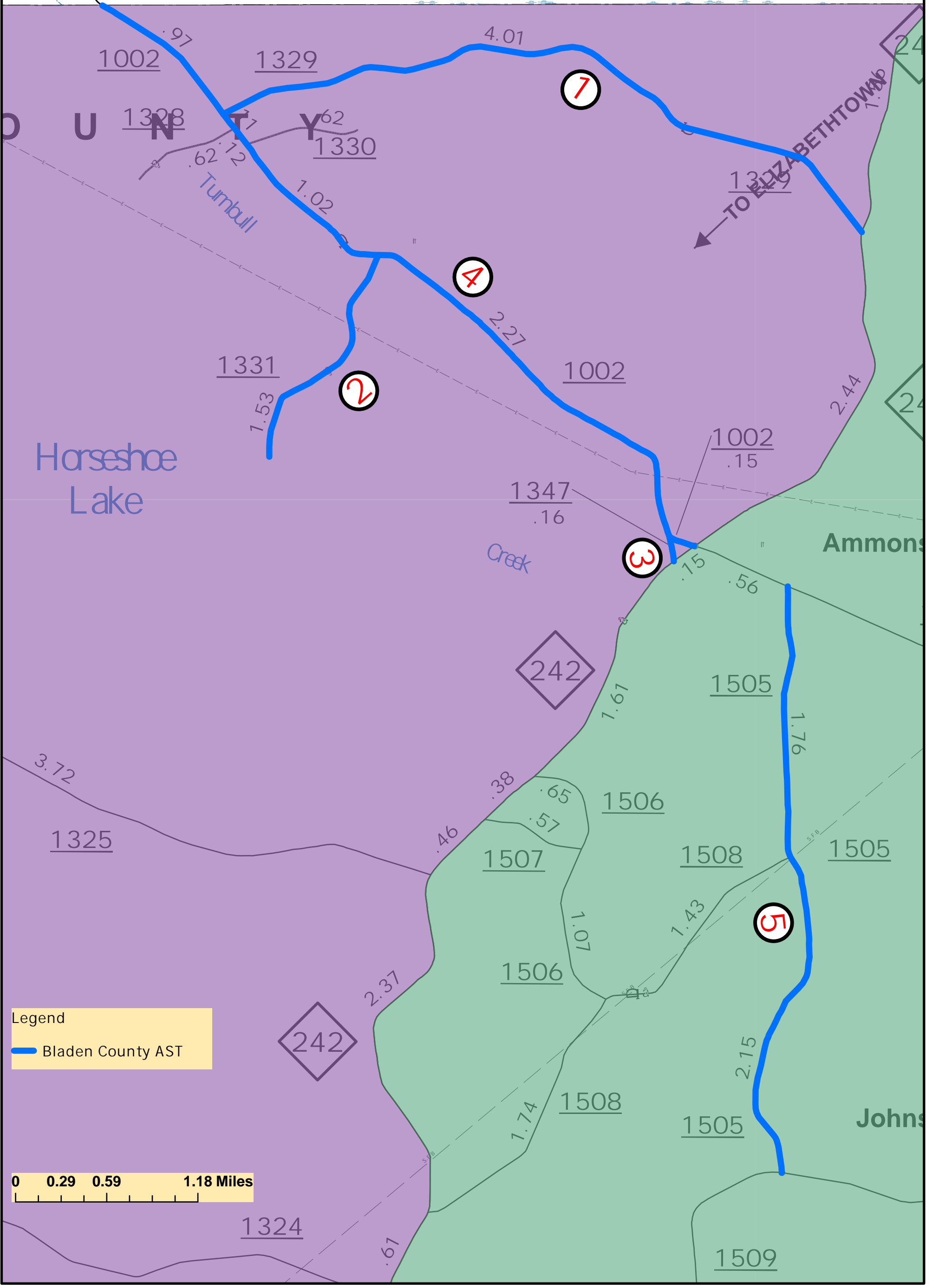

# PAVEMENT SCHEDULE

F1	DOUBLE SEAL PLACED ACCORDING TO THE SPECIAL PROVISION
F2	TRIPLE SEAL PLACED ACCORDING TO THE SPECIAL PROVISION
T	EXISTING SHOULDER
U	EXISTING ASPHALT PAVEMENT

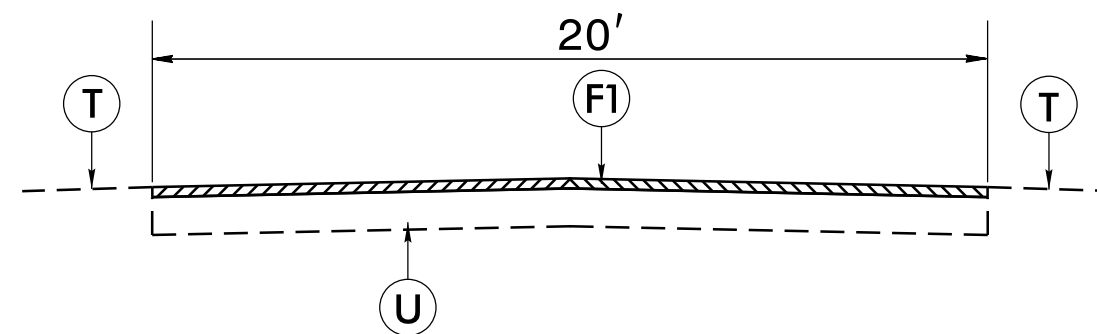

TYPICAL SECTION NO. 1

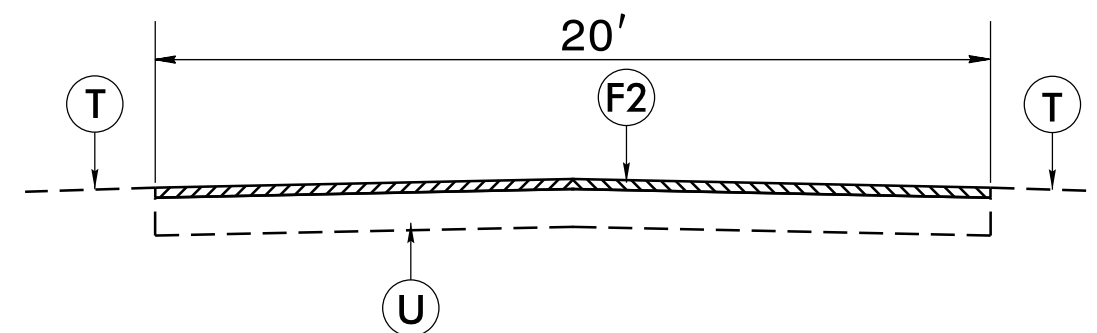

TYPICAL SECTION NO. 2

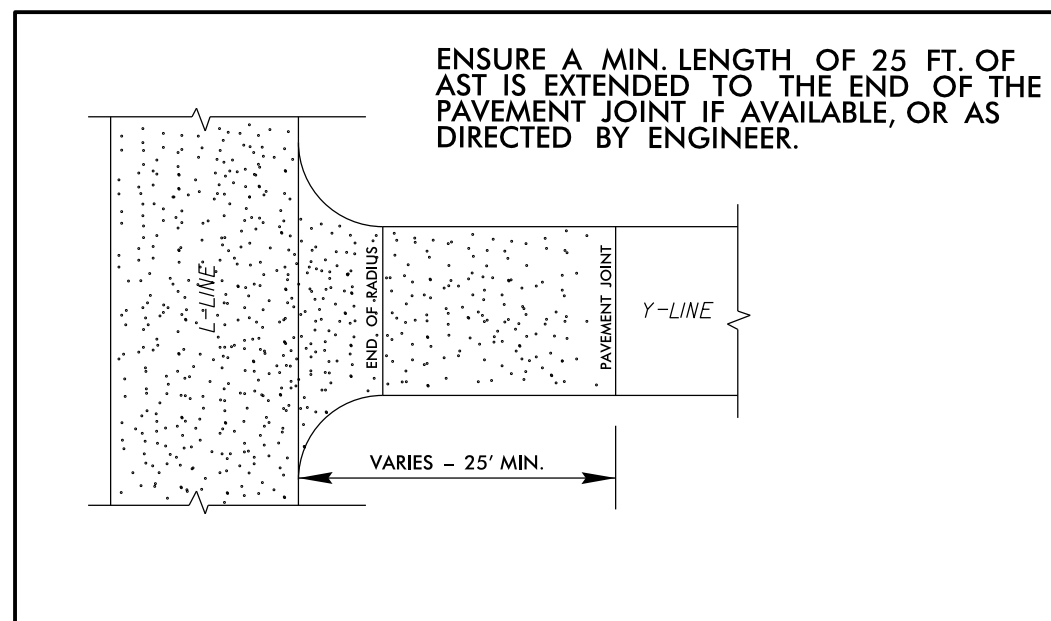

ENSURE A MIN. LENGTH OF 25 FT. OF AST IS EXTENDED TO THE END OF THE PAVEMENT JOINT IF AVAILABLE, OR AS DIRECTED BY ENGINEER.

DETAIL 1

-Y- LINE INTERSECTION TREATMENT

21-SEP-2023 07:54  
 C:\Users\jgibson\OneDrive\Documents\2024CPT.06.05.20092.1.AST\_Bladen\Plans\typ.dgn  
 2024CPT.06.05.20092.1

# SIGNING FOR ASPHALT SURFACE TREATMENT

**LEGEND**

- PORTABLE SIGN
- STATIONARY SIGN
- DIRECTION OF TRAFFIC FLOW

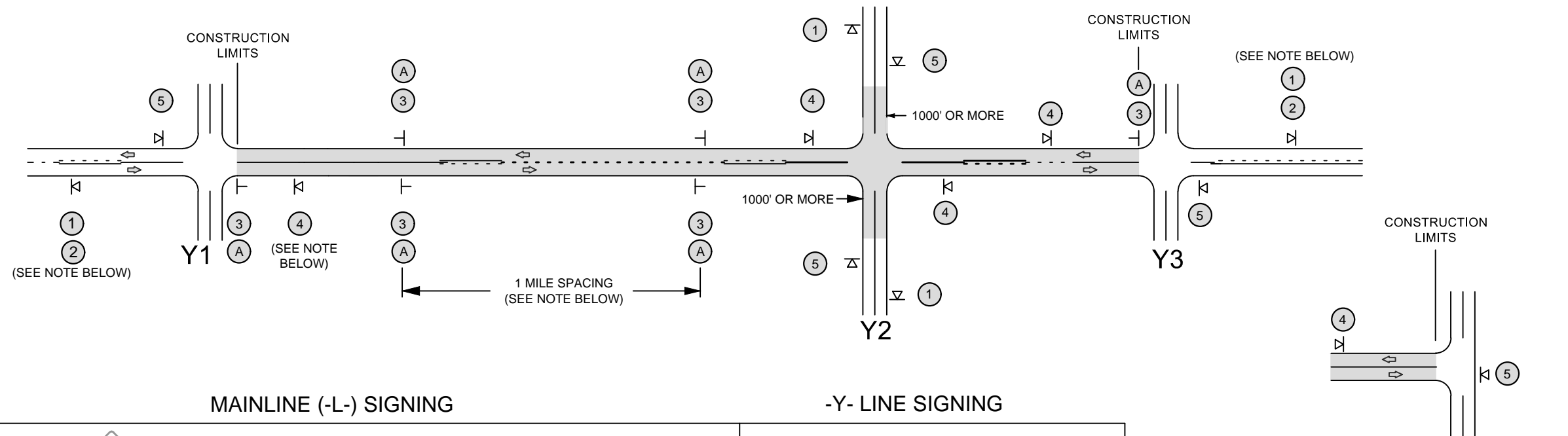

## MAINLINE (-L-) SIGNING

## -Y- LINE SIGNING

SIGNING NOTES AND PLACEMENT PER DIRECTION	<p>① ROAD WORK AHEAD W20-1 48" X 48"</p> <p>② NEXT XX MILES W7-3aP 24" X 18"</p>	<p>- PLACE 1000' PRIOR TO BEGINNING OF CONSTRUCTION LIMITS. ONLY USED ON -Y- LINES IF RESURFACING LIMITS EXTEND 1000' ALONG -Y- LINE.</p> <p>- SIGN #2 ONLY USED WHEN RESURFACING LIMITS ARE 2 OR MORE MILES IN LENGTH. ROUND UP TO THE NEAREST WHOLE NUMBER. DO NOT USE FRACTIONAL OR DECIMAL NUMBERS.</p>
	<p>③ LOOSE GRAVEL W8-7 48" X 48"</p> <p>UNMARKED PAVEMENT SP 48" X 48"</p>	<p>- ALTERNATE THE FOLLOWING TWO SIGNS:</p> <p>- STARTING WITH "LOOSE GRAVEL" (W8-7) FOLLOWED BY "UNMARKED PAVEMENT".</p> <p>- PLACE INITIALLY AT THE CONSTRUCTION LIMITS AND SPACED 1 MILE APART THEREAFTER.</p> <p>- AT TEE INTERSECTIONS INSTALL INITIALLY 0.5 MILE FROM INTERSECTION AND SPACE 1 MILE APART THEREAFTER.</p>
	<p>A SPEED LIMIT 35 W13-1P 18" X 18"</p>	<p>PLACE INITIALLY AT THE CONSTRUCTION LIMITS AND SPACED 1 MILE APART THEREAFTER. IF NO -Y- LINES EXIST, PLACE 2ND SET 1/2 MILE FROM THE CONSTRUCTION LIMITS AND THEN SPACE 1 MILE THEREAFTER. SPEED LIMIT SIGN MAY BE PLACED ON SAME POST AS LOOSE GRAVEL SIGN, IF DESIRED.</p>
	<p>④ ROAD UNDER CONST SP 13106 48" X 48"</p>	<p>- THESE ARE FOR -Y- LINES THAT ARE "THROUGH" ROADWAYS. DEAD END AND SUBDIVISION ROADS ARE NOT "THROUGH" ROADWAYS.</p> <p>- INSTALL 500' +/- FROM EACH -Y- LINE APPROACH AS SHOWN ABOVE.</p> <p>- FOR MULTIPLE -Y- LINES THAT ARE SEPARATED BY 0.25 MILES OR LESS, TREAT AS A SINGLE UNIT AND INSTALL WITHIN 500' OF EACH APPROACH.</p> <p>- A MAXIMUM OF 2 SIGN SETS PER MILE. DO NOT INSTALL WHEN -Y- LINES ARE WITHIN 0.5 MILES FROM "END ROAD WORK" SIGN.</p>
	<p>⑤ END ROAD WORK G20-2 A 48" X 24"</p>	<p>PLACE 500' FOLLOWING THE END OF CONSTRUCTION LIMITS OR AS SHOWN WHEN WORK ENDS AT A 3-WAY TEE INTERSECTION.</p>

STATIONARY SIGNING NOT REQUIRED FOR THE FOLLOWING -Y- LINE CONDITIONS:

- LESS THAN 1000' OF RESURFACING ALONG -Y- LINE
- SUBDIVISION ROADS
- DEAD END ROADS

WHEN PAVING/CONSTRUCTION ACTIVITIES PROCEED ACROSS AN UNSIGNED -Y- LINE, PORTABLE ADVANCE WARNING SIGNS SHALL BE USED ALONG THE -Y- LINE AS SHOWN BELOW. REMOVE UPON COMPLETION OF WORK.

PLACED 500' IN ADVANCE OF FLAGGER.

PLACED 250' IN ADVANCE OF FLAGGER.

**NOTE:**  
IT IS THE CONTRACTOR'S RESPONSIBILITY TO ENSURE THE PROPER PLACEMENT AND LOCATION OF WORK ZONE SIGNING PER THE STANDARD DRAWING. NCDOT HAS THE RIGHT TO INSPECT THE PLANNED LOCATIONS AND REQUIRE ADJUSTMENT BY THE CONTRACTOR, AS NEEDED, OR AS DIRECTED BY THE ENGINEER.

**MAPS LESS THAN 2 MILES**

FOR AST RESURFACING MAPS WITH CONSTRUCTION LIMITS LESS THAN 2 MILES IN LENGTH, USE A STATIONARY "LOOSE GRAVEL" SIGN AT THE BEGINNING CONSTRUCTION LIMIT FOLLOWED BY AN "UNMARKED PAVEMENT" SIGN MIDWAY THROUGH AND AN "END ROAD WORK" SIGN AT THE END CONSTRUCTION LIMIT.

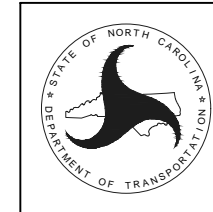

REVISED - 12-13-2018

NCDOT - DIVISION 6

ADVANCE WARNING SIGNS FOR 2-LANE ROADWAY ASPHALT SURFACE TREATMENT

PROJECT NO.	SHEET NO.	TOTAL NO.
2024CPT.06.05.20092.1		

## SUMMARY OF QUANTITIES

PROJECT NO	COUNTY	MAP NO	ROUTE	DESCRIPTION	TYP NO	LANES	LANE TYPE	FINAL SURFACE TESTING REQUIRED	WARM MIX ASPHALT REQUIRED	LENGTH	WIDTH	BEGIN MP	END MP	1803500000-E	1836000000-E	1838000000-E
										MI	FT			ASPHALT SURFACE TREATMENT, DOUBLE SEAL	ASPHALT SURFACE TREATMENT, TRIPLE SEAL	EMULSION FOR ASPHALT SURFACE TREATMENT
														SY	SY	GAL
2024CPT.06.05.20092.1	Bladen	1	SR-1329 / F L MCDANIEL RD	FROM SR 1002 TO NC 242	1	2		NO	NO	4.01	20	0	4.01	47,051		25,878
2024CPT.06.05.20092.1	Bladen	2	SR-1331 / BRAXTON EDGE RD	FROM SR 1002 TO DEAD END	1	2		NO	NO	1.52	20	0	1.52	17,835		9,809
2024CPT.06.05.20092.1	Bladen	3	SR-1347 / AMMON COMMUNITY CENTER RD	FROM NC 242 TO SR 1002	1	2		NO	NO	0.16	20	0	0.16	1,877		1,032
2024CPT.06.05.20092.1	Bladen	4	SR-1002 / OLD FAYETTEVILLE RD	FROM NC 242 TO CUMBERLAND COUNTY LINE	1	2		NO	NO	4.9	20	8.15	13.05	57,493		31,621
2024CPT.06.05.20092.1	Bladen	5	SR-1505 / JACK RICHARDSON RD	FROM SR 1002 TO SR 1509	2	2		NO	NO	3.91	20	0	3.91		45,877	36,243
<b>TOTAL FOR PROJ NO. 2024CPT.06.05.20092.1</b>										<b>14.5</b>		<b>8.15</b>	<b>22.65</b>	<b>124,256</b>	<b>45,877</b>	<b>104,583</b>
<b>GRAND TOTAL</b>										<b>14.5</b>		<b>8.15</b>	<b>22.65</b>	<b>124,256</b>	<b>45,877</b>	<b>104,583</b>

PROJECT NO.	SHEET NO.	TOTAL NO.
2024CPT.06.05.20092.1		

## THERMOPLASTIC AND PAINT QUANTITIES

PROJECT NO	COUNTY	MAP NO	ROUTE	DESCRIPTION	TYP NO	LANES	LANE TYPE	LENGTH	WIDTH	BEGIN MP	END MP	4413000000-E WORK ZONE ADVANCE/GENERAL WARNING SIGNING	4457000000-N TEMPORARY TRAFFIC CONTROL
								MI	FT			SF	LS
								2024CPT.06.05.20092.1	Bladen	1	SR-1329 / F L MCDANIEL RD	FROM SR 1002 TO NC 242	
2024CPT.06.05.20092.1	Bladen	2	SR-1331 / BRAXTON EDGE RD	FROM SR 1002 TO DEAD END		2	1.52	20	0	1.52	112	1.52	
2024CPT.06.05.20092.1	Bladen	3	SR-1347 / AMMON COMMUNITY CENTER RD	FROM NC 242 TO SR 1002		2	0.16	20	0	0.16	112	0.16	
2024CPT.06.05.20092.1	Bladen	4	SR-1002 / OLD FAYETTEVILLE RD	FROM NC 242 TO CUMBERLAND COUNTY LINE		2	4.9	20	8.15	13.05	275	4.90	
2024CPT.06.05.20092.1	Bladen	5	SR-1505 / JACK RICHARDSON RD	FROM SR 1002 TO SR 1509		2	3.91	20	0	3.91	275	3.91	
<b>TOTAL FOR PROJ NO. 2024CPT.06.05.20092.1</b>								<b>14.5</b>		<b>8.15</b>	<b>22.65</b>	<b>1,055</b>	<b>14.500</b>
<b>GRAND TOTAL</b>								<b>14.5</b>		<b>8.15</b>	<b>22.65</b>	<b>1,055</b>	<b>14.500</b>